

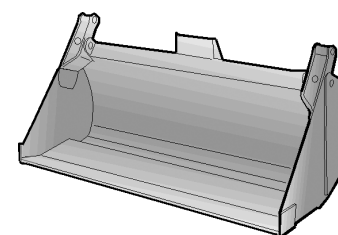

I DOTAZIONE STANDARD

BENNA 4 in 1 con tubazioni in gomma per alimentazione circuito idraulico, kit di attacco universale per Skid - Steer Loader.



GB STANDARD EQUIPMENT

BUCKET 4 in 1 with rubber pipes for hydraulic circuit, universal attack kit for Skid - Steer Loader.

BM 125

| | | CODICE CODE | | PREZZO PRICE |
|--|-------------------------------------|---------------------|------------|----------------|
| BOB - CAT S100 KOMATSU SK510 GEHL SL3840 MUSTANG 2026 THOMAS T105 NEUSON 501S EUROCCOMACH ESK130 CAMS LIBRA 635 | LARGHEZZA <i>WIDTH</i> | mm 1250 | 125.BM.100 | (1) € 2.600,00 |
| | PESO <i>WEIGHT</i> | Kg 220 | | |
| | CAPACITA' <i>CAPACITY</i> | m ³ 0,23 | | |
|  UNIVERSAL PLATE | | | | |

BM 140

| | | CODICE CODE | | PREZZO PRICE |
|--|-------------------------------------|---------------------|------------|----------------|
| NEW HOLLAND LS140 GEHL SL3840 - SL4240 JCB-ROBOT 160 MUSTANG 2026 - 2041 THOMAS T105 | LARGHEZZA <i>WIDTH</i> | mm 1400 | 140.BM.100 | (1) € 2.750,00 |
| | PESO <i>WEIGHT</i> | Kg 250 | | |
| | CAPACITA' <i>CAPACITY</i> | m ³ 0,26 | | |
|  UNIVERSAL PLATE | | | | |

BM 155

| | | CODICE CODE | | PREZZO PRICE |
|--|-------------------------------------|---------------------|------------|----------------|
| CAT 216B - 226B - 232B BOB - CAT S130 - S150 - S160 KOMATSU SK714 NEW HOLLAND LS150 GEHL SL4240 JCB-ROBOT 160 - 170 - 1CX CASE 410 - 420 MUSTANG 2041 - 2044 - 2054 THOMAS T153 NEUSON 701S | LARGHEZZA <i>WIDTH</i> | mm 1550 | 155.BM.100 | (1) € 2.900,00 |
| | PESO <i>WEIGHT</i> | Kg 275 | | |
| | CAPACITA' <i>CAPACITY</i> | m ³ 0,30 | | |
|  UNIVERSAL PLATE | | | | |

BM 168

| | | CODICE CODE | | PREZZO PRICE |
|---|-------------------------------------|---------------------|------------|----------------|
| CAT 236B - 242B - 246B - 247B - 248B - 257B BOB - CAT S150 - S160 - S175 - S185 - T190 KOMATSU SK815 - SK818 - SK820 - CK20 - CK25 NEW HOLLAND LS160 - LS170 GEHL SL4640 - SL4840 JCB-ROBOT T180 CASE 430 - 440 | LARGHEZZA <i>WIDTH</i> | mm 1680 | 168.BM.100 | (1) € 3.050,00 |
| | PESO <i>WEIGHT</i> | Kg 330 | | |
| | CAPACITA' <i>CAPACITY</i> | m ³ 0,37 | | |
|  UNIVERSAL PLATE | | | | |

BM 185

| | | CODICE CODE | | PREZZO PRICE |
|---|-------------------------------------|---------------------|------------|----------------|
| CAT 247B - 248B - 257B - 262B - 268B - 277B BOB - CAT S220 - S250 - S300 KOMATSU SK818 - SK820 - SK1020 - SK1026 - CK20 - CK25 NEW HOLLAND L175 - C175 - LS180B - LS185B GEHL SL5640 - SL6640 JCB-ROBOT 190 - T190 - 1110 CASE 435 - 445 - 440 CT | LARGHEZZA <i>WIDTH</i> | mm 1850 | 185.BM.100 | (1) € 3.350,00 |
| | PESO <i>WEIGHT</i> | Kg 370 | | |
| | CAPACITA' <i>CAPACITY</i> | m ³ 0,41 | | |
|  UNIVERSAL PLATE | | | | |

BM 205

| | | CODICE CODE | | PREZZO PRICE |
|--|-------------------------------------|---------------------|------------|----------------|
| CAT 277B - 287B - 297C BOB - CAT T250 - T300 KOMATSU SK1020 - SK1026 - CK30 - CK35 NEW HOLLAND C185 GEHL 7810 JCB-ROBOT T1110 MUSTANG 2109 NEUSON 1101C TAKEUCHI TL140 - TL150 | LARGHEZZA <i>WIDTH</i> | mm 2050 | 205.BM.100 | (1) € 3.700,00 |
| | PESO <i>WEIGHT</i> | Kg 420 | | |
| | CAPACITA' <i>CAPACITY</i> | m ³ 0,45 | | |
|  UNIVERSAL PLATE | | | | |

(1) Per minipale con piastra di attacco non universale : +€180,00
 For skid-steer loader with attack plate not universal : + €180,00

N.B. Serie denti per benna vedi pag. 36
 Teeth kit for buckets pag. 36